

INSTALLATION GUIDE

DANOfile XTRA

KNAUF DANOLINE



DANOfile XTRA(A)

- Lay-in tile for demountable hygiene ceiling
- Installation in exposed T-grid
- Edge A

CONDITIONS OF USE

- For internal fitout of buildings
- To be installed in a closed-off building

STORAGE

The products must be:

- stored indoors clean and dry
- positioned on a level base
- protected from direct moisture
- stored at humidities of less than 70% RH and temperatures of less than 50°C
- protected from impact and shock
- stacked max. 2 pallets on top of each other

PACKAGING OPENING

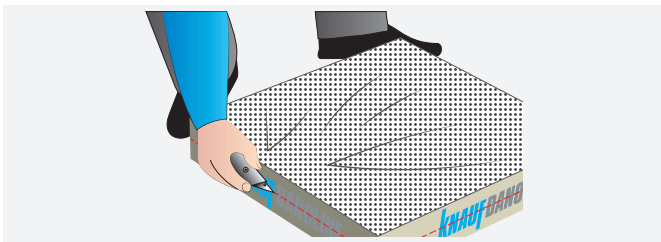

- Cut the plastic wrapping by running a knife along the sides of the package. Do not cut the plastic on top of the package.

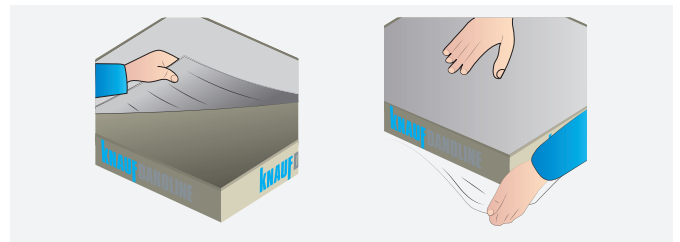

- Remove the plastic wrapping.

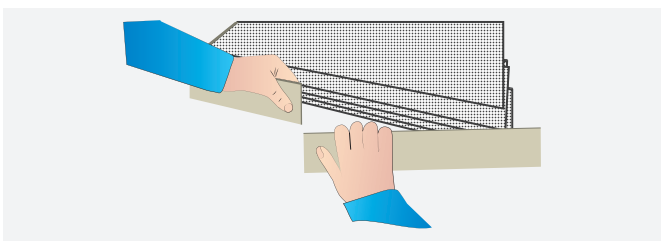

- Remove the cardboard liner around the ceiling tiles.

INSTALLATION GUIDE DANOfile XTRA (A)

CEILING LAYOUT

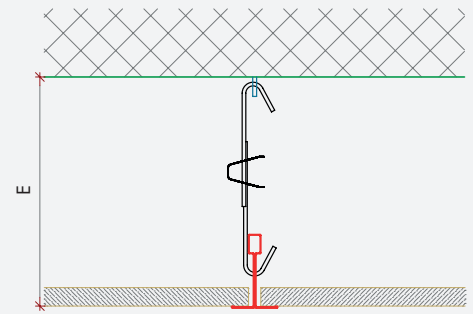
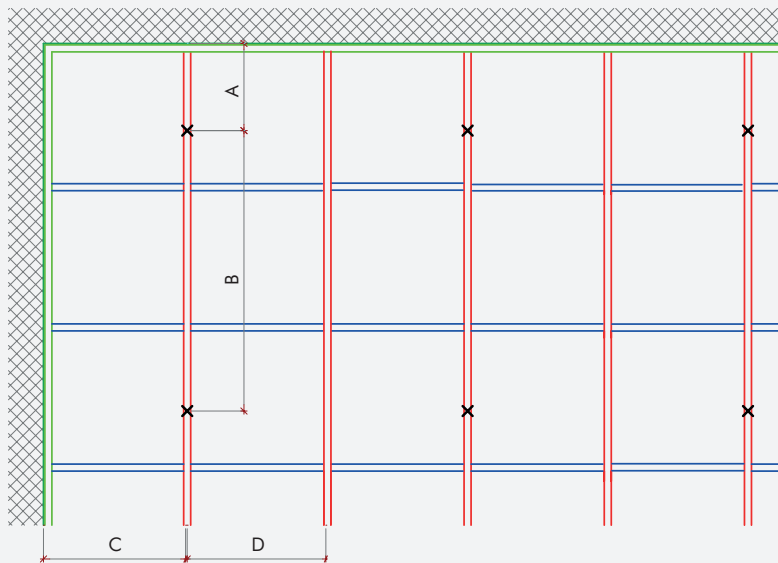

Legend:

- Wall angle or shadow line trim
- Main runner T24
- Cross tee T24, 1200 mm
- Adjustable hanger (type depends on installation depth)

A = Max. 400 mm B = Max. 1200 mm C = Max. 600 mm D = 600 mm E = Min. 120 mm

RECOMMENDED ACCESSORIES

Below accessories are tested and approved for use in connection with DANOfile XTRA.

	PRODUCT NAME	SAP NO.	W x L x H (mm)
	Main runner T24	467385	24 x 3700 x 38
	Cross tee T24	467388	24 x 600 x 38
T-grid	 Adjustable hanger The size specification indicates the min. and max. range	469861	165 - 280
		469868	315 - 580
		469872	510 - 970
		469876	630 - 1210
		469878	755 - 1460
		469880	900 - 1750
	Wall angle type MIE2024	434023	20 x 3000 x 24
	Shadow line trim type MS15	316335	15+15x3000/8+25
Extra	Outside corner for wall angle	109100	
	Inside corner for wall angle	109102	
	Hold down clip	430744	-

INSTALLATION GUIDE DANOfile XTRA (A)

INSTALLATION

Before installation, please ensure that fixtures to primary construction can withstand the load of the ceiling.
Best Practice: Use of clean cotton gloves when handling tiles will ensure a good result and a ceiling without fingermarks.

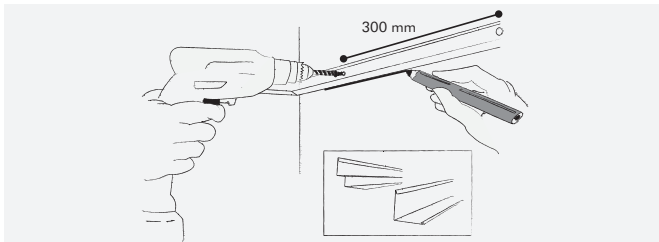

WALL ANGLES

- Mark the location of the wall angles on the walls and columns in relation to the required ceiling height.
- Fix the wall angles at max. 300 mm c/c. Choose the fixings in accordance with the substrate.

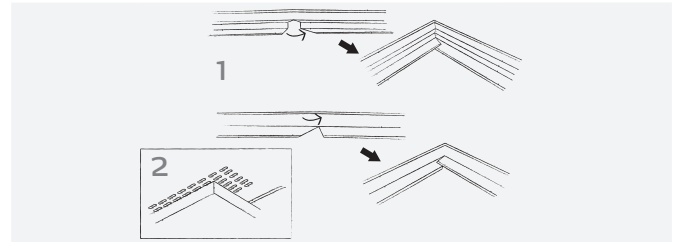

CORNERS

- Inside corners (1): cut the corners in a false mitre letting the ends overlap each other, unless anything to the contrary is specified.
- Outside corners (2): must always be mitred.

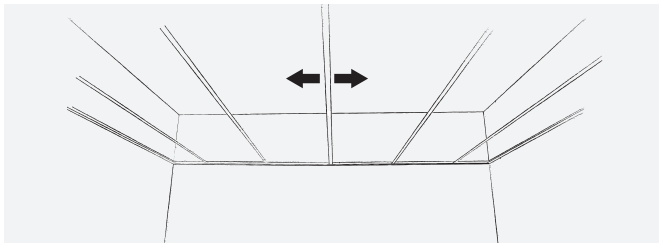

CEILING LAYOUT

- Divide the ceiling surface from the centre of the room or in accordance with the existing ceiling plans.
- The location of light fittings and ventilation units will have an influence on ceiling layout.
- The first main runner is installed at max. 600 mm from the wall. The other main runners should be installed at 600mm c/c.

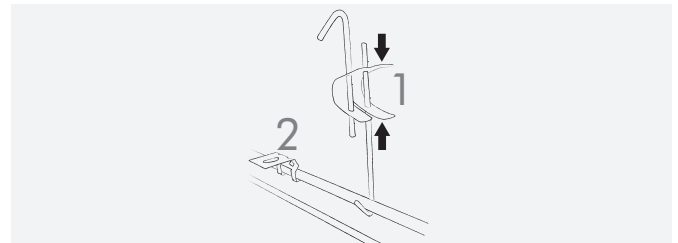

HANGERS

- Fix adjustable hangers (1) with eye screws or similar securely fastened to the primary construction.
- Direct hangers (2) are secured to the ceiling using appropriate fixings in accordance with the substrate.
- Install the first hanger at max. 400 mm from the wall. The other hangers should be installed at max. 1200 mm c/c.
- If loads from light fittings etc. are to be borne by the ceiling, install additional hangers.
- Refer to distances in ceiling layout drawing

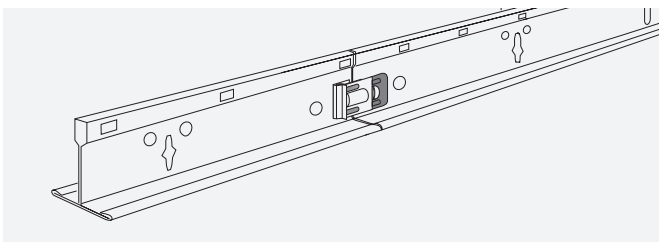

MAIN RUNNERS

- Install the main runners parallel to each other so that the slots are directly opposite each other.
- Join the main runners longitudinally by clicking them together.
- Adjust the lengths of the profiles with plate shears, a hacksaw or a cross-cut saw with a special blade.
- Make sure there is a hanger between the end joints of the main runners and the fire break.

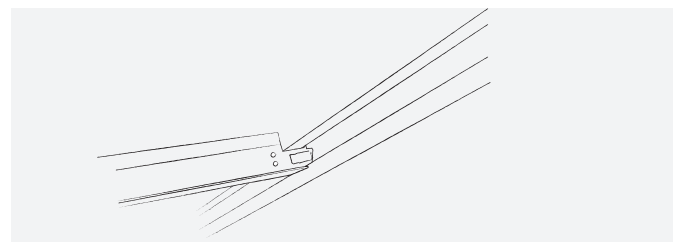

CROSS PROFILES

- Push the snap-in tongue into the slot on the main runner until it securely clicks into place.
- If there is a cross profile on the opposite side of the main runner, the new one must be on the left hand side of the one already in place.

INSTALLATION GUIDE DANOfile XTRA (A)

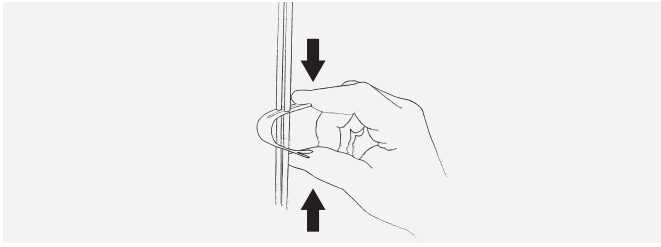

ADJUSTMENT

- Check that all profiles are correctly aligned when the entire suspension grid has been installed.
- Adjust the hangers so that they are taut and the ceiling surface is level.

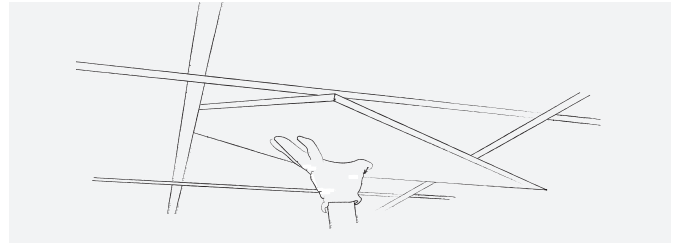

INSTALLATION

- Always wear clean cotton gloves when handling ceiling tiles.
- Install the tiles by tilting them up between the T-profiles.

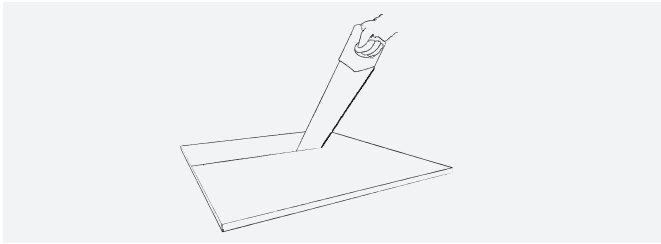

CUTTING

- Cut the tiles to size from the front face with a fine-toothed saw.

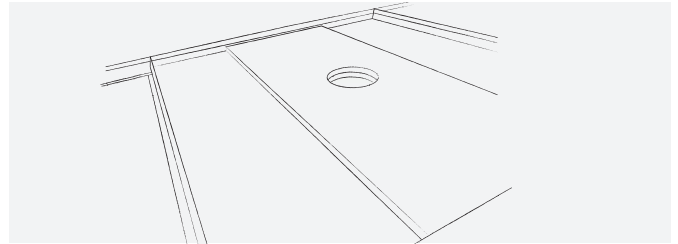

FIXTURES AND FITTINGS

- For sizes up to 600x600 and min. thickness 12.5mm, units of up to 3kg can be installed directly into the tile without reinforcement.
- The total weight should not be greater than 3kg for each m² of ceiling. Where loads are greater than 3kg/m², additional hangers must be used.
- Units over 3kg, should be installed independently, so that they do not place any load on the ceiling.